

19

20

30

29

# MUNICIPALITY OF FORADA

PREPARED BY THE  
MINNESOTA DEPARTMENT OF TRANSPORTATION  
OFFICE OF TRANSPORTATION SYSTEM MANAGEMENT

IN COOPERATION WITH  
U.S. DEPARTMENT OF TRANSPORTATION  
FEDERAL HIGHWAY ADMINISTRATION

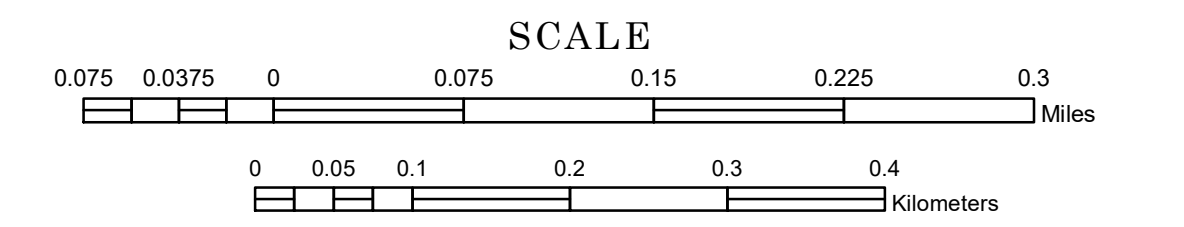

1 in = 400 ft  
**2023**

Projection:  
Transverse Mercator  
NAD 1986  
UTM Zone 15



North American Datum  
of 1986

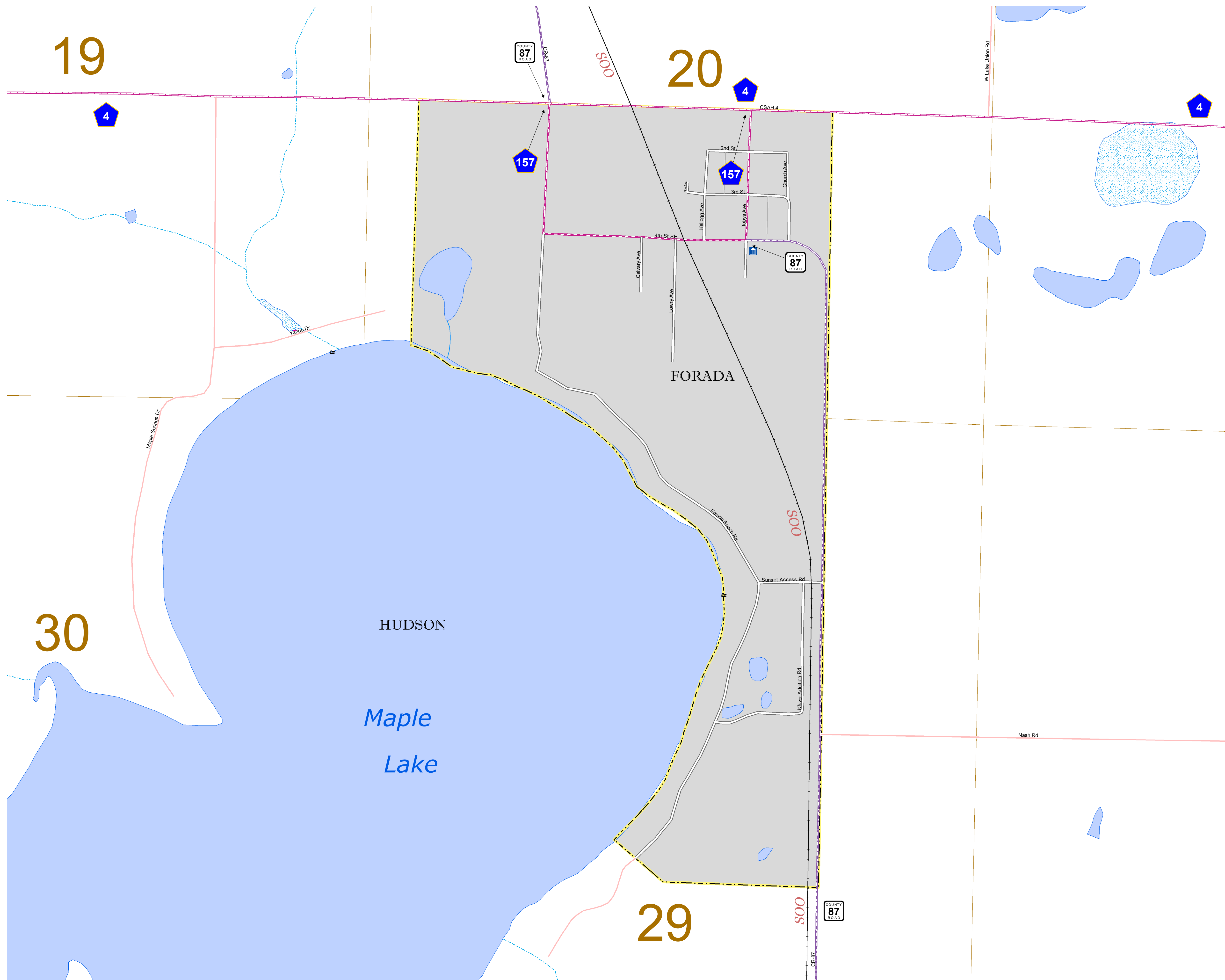

ROAD AND ROADWAY FEATURES	PUBLIC SERVICE FEATURES
INTERSTATE	MINOT OFFICE
US HIGHWAY	MINOT TRUCK STATION
BN HIGHWAY	HIGHWAY PATROL DISTRICT OFFICE
COUNTY STATE AID HIGHWAY	STATE TRAVEL INFORMATION CENTER
MUNICIPAL STREET	REST AREA (Full Service)
COUNTY ROAD	REST AREA (Quick Turn)
MUNICIPAL STREET	WAYSIDE (Only on Pk or Trk)
MUNICIPAL STATE AID STREET	PUBLIC ACCESS POINT
PRIVATE STREET/ROAD	LOCAL PARK
TOWNSHIP ROAD	FARMS/GRASSLANDS
UNORGANIZED TERRITORY ROAD	PORT OF ENTRY
RAMP OR CONNECTOR	PARK AND RIDE LOT
INTERSTATE EXIT	PUBLIC UNIVERSITY/COLLEGE
GREAT RIVER ROAD	PRIVATE UNIVERSITY/COLLEGE
OTHER ROADS	ELEMENTARY SCHOOL
FARMROAD	MIDDLE SCHOOL
STATE PARK	HIGH SCHOOL
NATIONAL MONUMENT	
NATIONAL FOREST	
STATE GAME	
RAILROAD AND RAILWAY FEATURES	AVIATION FEATURES
EMPIRE BUILDER STATION (Amtrak)	COMMERCIAL AIRPORT
NORTHSTAR STATION (Commuter)	GENERAL AIRPORT
LIGHT RAIL	AIRSTRIP
BLUE LINE STATION	SEAPLANE
GREEN LINE STATION	AIRPORT RUNWAY
INFRASTRUCTURE FEATURES	CULTURAL FEATURES
LONG BRIDGE (100' or Greater Span)	STATE HISTORICAL MARKER
MAJOR BRIDGE (20' to 100' Span)	HISTORIC DISTRICT
MINOR BRIDGE (0' to 20' Span)	HISTORIC SITE
ROAD TUNNEL (100' or Greater Span)	MONUMENT
RAILROAD BRIDGE (100' or Greater Span)	CEMETERY
RAILROAD BRIDGE (Lesser 100' Span)	
SKYWAY	
PEDESTRIAN BRIDGE	
PEDESTRIAN TUNNEL	
DAM	
LOCK AND DAM	
PUBLIC FACILITIES	BOUNDARY FEATURES
STATE CAPITOL	TRIBAL LAND
FEDERAL COURTHOUSE	COUNTY
COUNTY COURTHOUSE	MUNICIPALITY
ARMORY	ADJACENT MUNICIPALITY
CITY HALL	FEDERAL ADJUSTED URBAN AREA (2014)
TOWN HALL	MILITARY
COMMUNITY CENTER	STATE PARK
ARENA	REGIONAL PARK
STADIUM	NATIONAL AND STATE FOREST
POST OFFICE	STATE FOREST
POLICE STATION	NATIONAL TRAIL
FIRE STATION	WILDLIFE REFUGE AREA
PUBLIC LIBRARY	WILDLIFE MANAGEMENT AREA
PUBLIC MUSEUM	HYDROLOGIC FEATURES
EVENT CENTER	RIVER OR STREAM (Perennial)
	LAKE, POND OR RESERVOIR
	STREAM (Perennial/Intermittent)
	DRAINAGE DITCH
	WETLAND
	ISLAND OR LAND
	REGIONAL WATERSHED
CITY CENTERS	
TRIBAL GOVERNMENT CENTER	
CITY CENTER	
LOCALLY INCORPORATED PLACE	
UNINCORPORATED COMMUNITY	

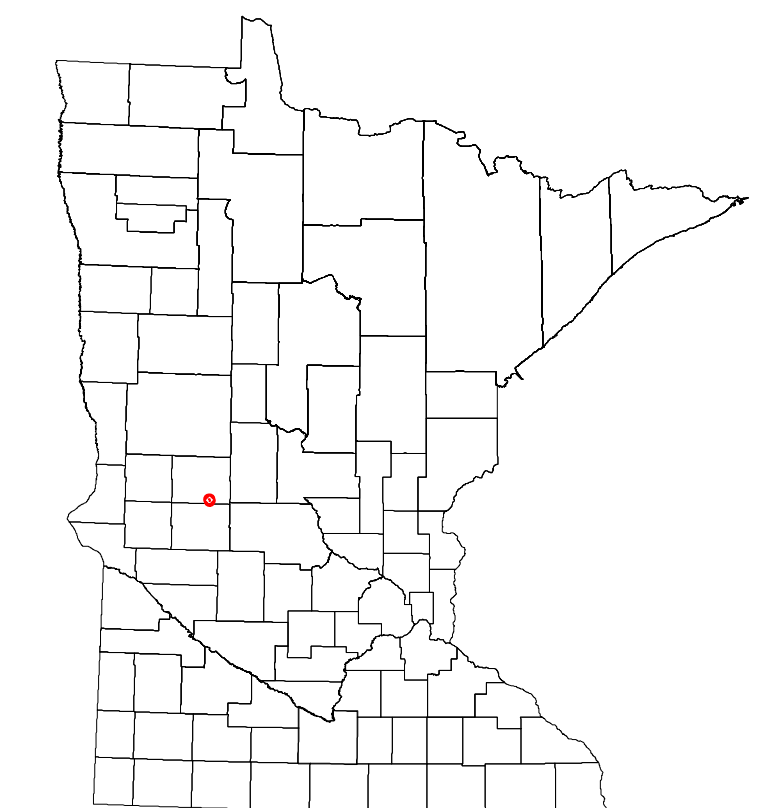

To request information from this document in an alternative format, call 651-366-4718 or 1-800-657-3774 (Greater Minnesota); 711 or 1-800-627-3529 (Minnesota Relay). You may also send an e-mail to ADAREquest.dot@state.mn.us. (Please request at least one week in advance.)

LAST EDITED ON 12-10-2023

Population (U.S. Census 2020): 170