

2004 TRUNK HIGHWAY VOLUMES  
GENERAL HIGHWAY MAP  
**GOODHUE  
COUNTY**  
MINNESOTA

PREPARED BY THE  
MINNESOTA DEPARTMENT OF TRANSPORTATION  
OFFICE OF TRANSPORTATION DATA & ANALYSIS  
IN COOPERATION WITH  
U.S. DEPARTMENT OF TRANSPORTATION  
FEDERAL HIGHWAY ADMINISTRATION

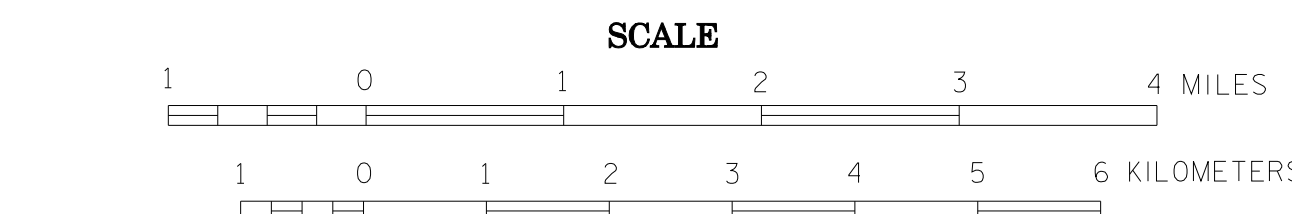

2004  
BASIC DATA - 1971\*

Projections  
Minnesota Coordinate System  
South Zone  
Lambert Conformal Conic

North American Datum  
of 1983

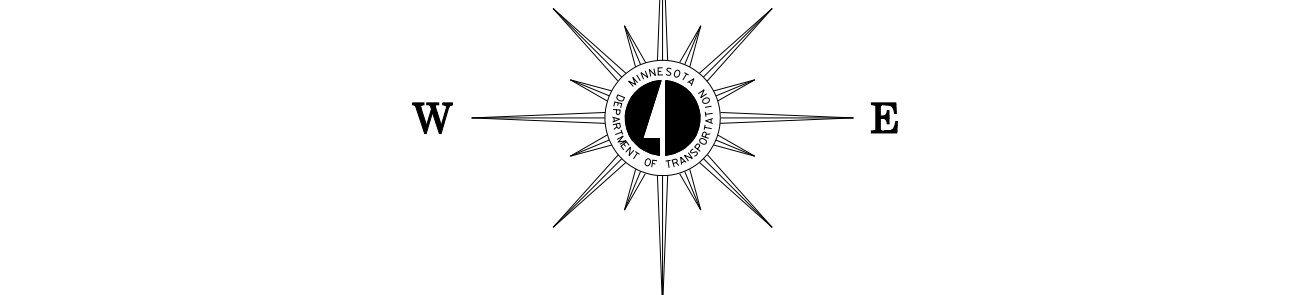

**LEGEND**

ROAD AND ROADWAY FEATURES	NAVIGATION	CONSERVATION	RECREATION	FARM AND DWELLING UNITS	INDUSTRIAL	COMMERCIAL	PUBLIC SERVICE FACILITIES	CITY CENTERS	MISCELLANEOUS MAP FEATURES	BOUNDARIES	DRAINAGE
PRIOR TO 1971	BASE LINES ON WATER COURSES	CONSERVATION	RECREATION	FARM UNIT	INDUSTRIAL PLANT	COMMERCIAL	PUBLIC SERVICE FACILITIES	CITY CENTER	CHAPEL	NATIONAL OR STATE	NATIONAL OR STATE
PRIOR TO 1971	SWAMP LINES ON ISLAND LINES	CONSERVATION	RECREATION	FARM UNIT	INDUSTRIAL PLANT	COMMERCIAL	PUBLIC SERVICE FACILITIES	CITY CENTER	CHAPEL	NATIONAL OR STATE	NATIONAL OR STATE
PRIOR TO 1971	SWAMP LINES ON ISLAND LINES	CONSERVATION	RECREATION	FARM UNIT	INDUSTRIAL PLANT	COMMERCIAL	PUBLIC SERVICE FACILITIES	CITY CENTER	CHAPEL	NATIONAL OR STATE	NATIONAL OR STATE
PRIOR TO 1971	SWAMP LINES ON ISLAND LINES	CONSERVATION	RECREATION	FARM UNIT	INDUSTRIAL PLANT	COMMERCIAL	PUBLIC SERVICE FACILITIES	CITY CENTER	CHAPEL	NATIONAL OR STATE	NATIONAL OR STATE

VOLUMES PREPARED BY  
THE OFFICE OF  
TRANSPORTATION DATA & ANALYSIS

NUMERALS INDICATE AVERAGE DAILY  
TRAFFIC VOLUMES ON DESIGNATED ROADS.

TRUNK HIGHWAY ROUTES ARE 2004 A.A.D.T. VOLUMES.

FOR DESIGNATED ROADS :  
/ = SEGMENT ENDPOINT FOR ALL  
ROADS INTERSECTED BY HATCH  
( = SEGMENT ENDPOINT ONLY FOR  
ROAD SEPARATED FROM INTERSECTING  
ROAD BY ARC

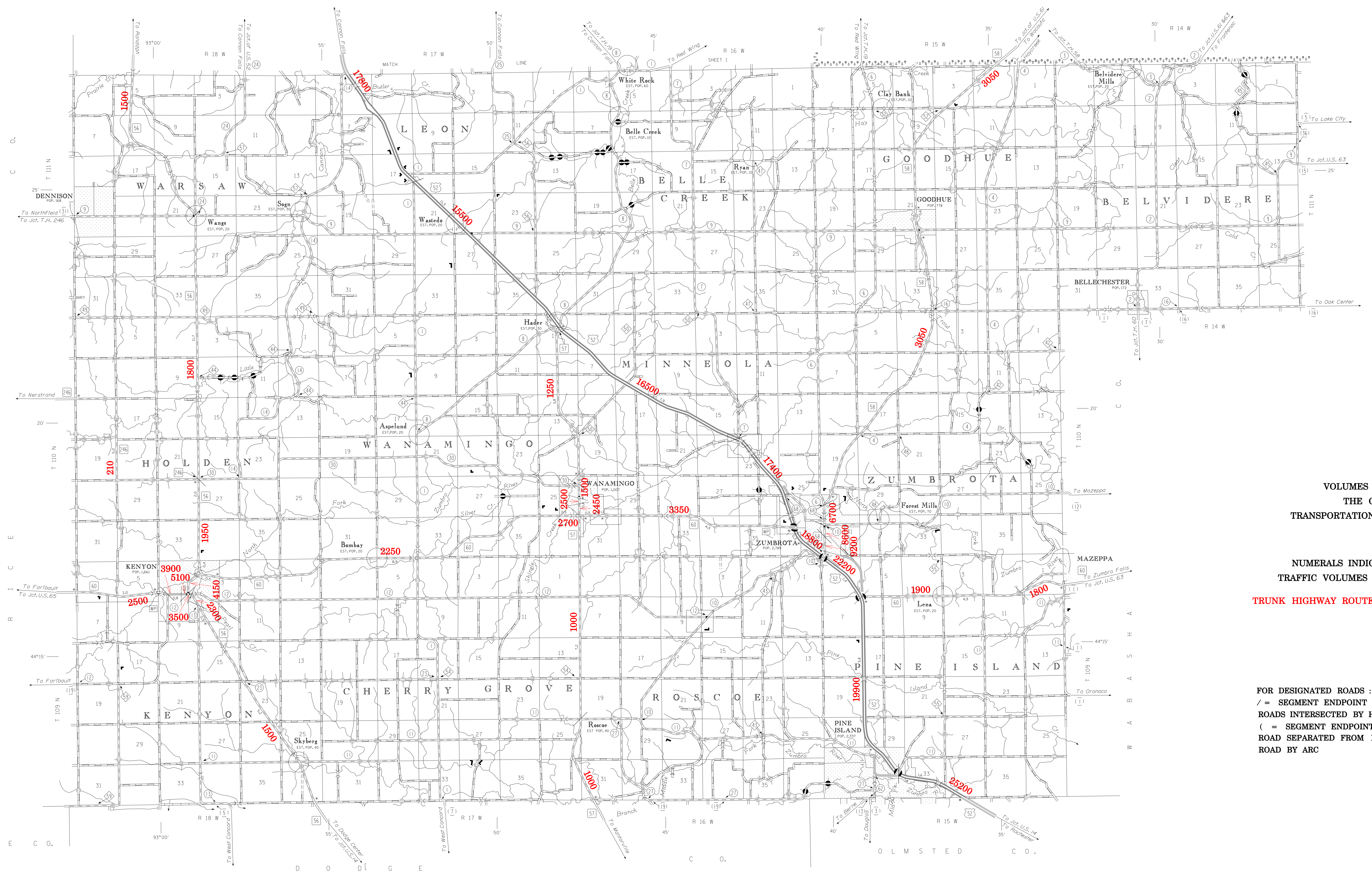

\*NOTE: ALL FEATURES EXCEPT TOWNSHIP ROADS AND  
CITIES ARE CURRENT AS OF JANUARY 1, 2004.

NOTE: FOR DETAIL OF COUNTY STATE AID HIGHWAYS AND COUNTY  
ROADS IN INCORPORATED PLACES, SEE MAPS OF MUNICIPALITIES.

