

2004 TRUNK HIGHWAY VOLUMES
GENERAL HIGHWAY MAP

GRANT COUNTY MINNESOTA

PREPARED BY THE
MINNESOTA DEPARTMENT OF TRANSPORTATION
OFFICE OF TRANSPORTATION DATA & ANALYSIS
IN COOPERATION WITH
U.S. DEPARTMENT OF TRANSPORTATION
FEDERAL HIGHWAY ADMINISTRATION

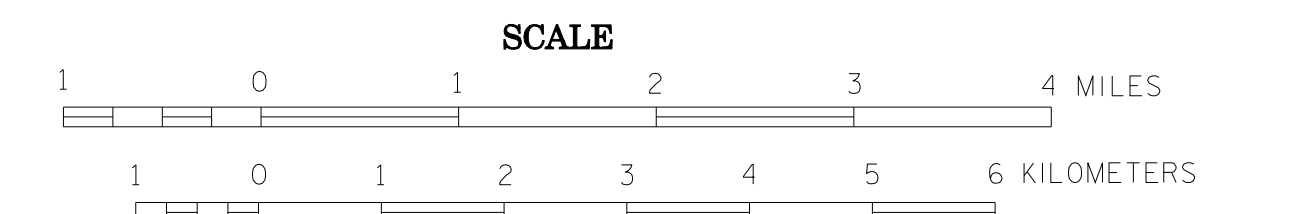

2004
BASIC DATA - 1977*

Projection:
Minnesota Coordinate System
Central Zone
Lambert Conformal Conic

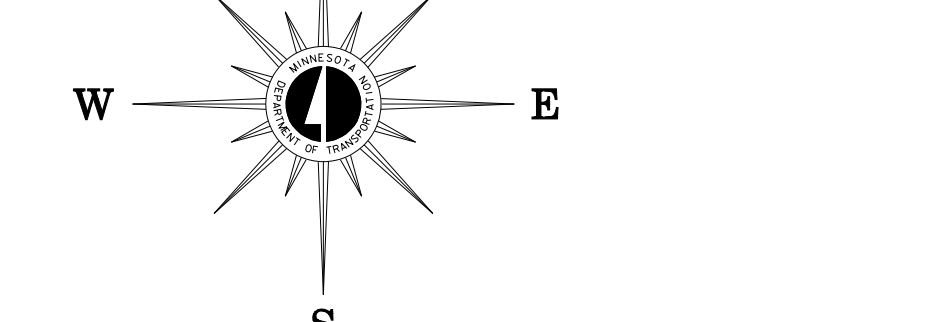

LEGEND

Legend table with 10 columns: ROAD AND ROADWAY FEATURES, NAVIGATION, CONSERVATION, RECREATION, FARM AND DWELLING UNITS, AIRWAYS, PUBLIC SERVICE FACILITIES, CITY CENTERS, MISCELLANEOUS MAP FEATURES, BOUNDARIES, and DRAINAGE.

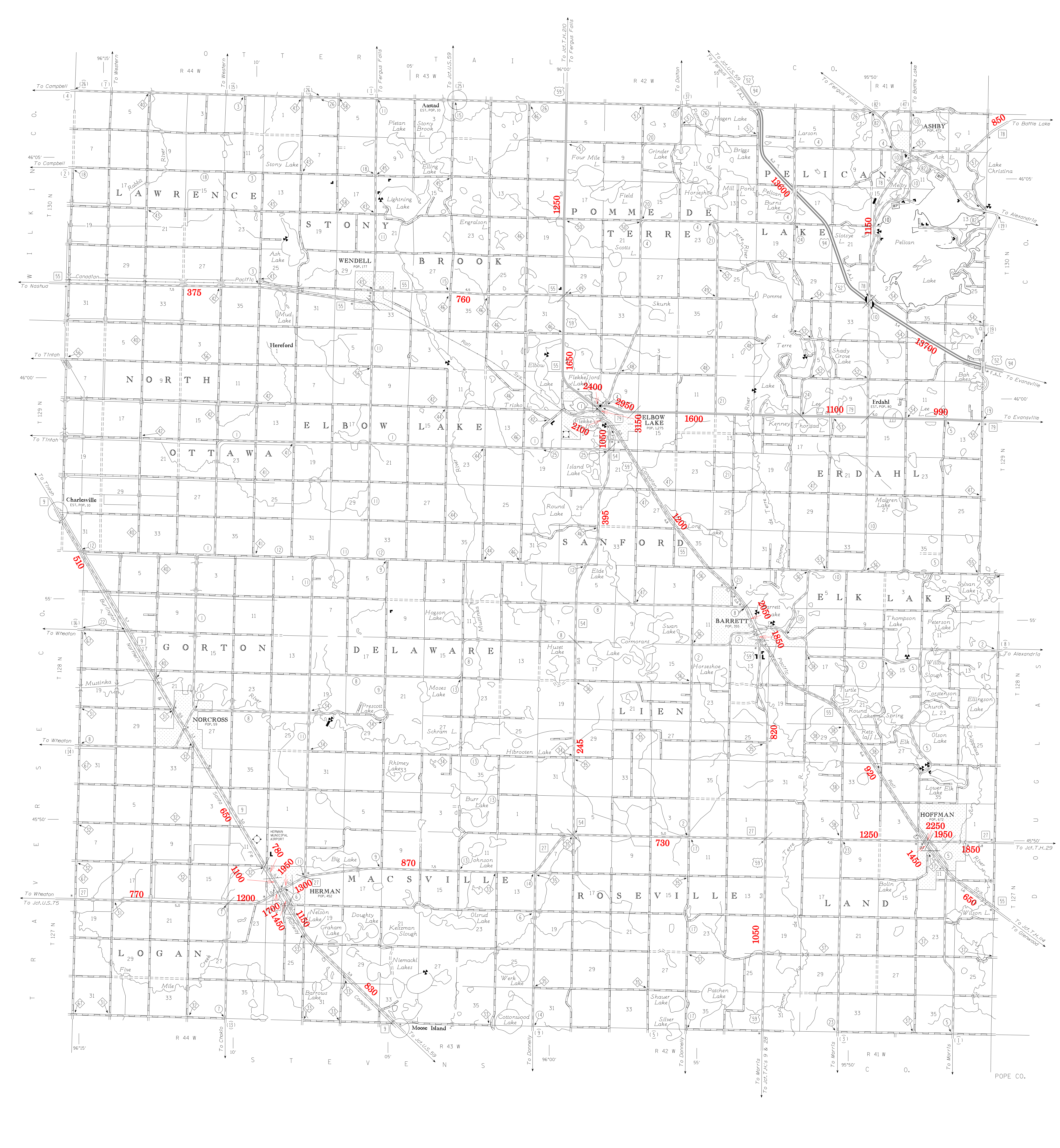

VOLUMES PREPARED BY
THE OFFICE OF
TRANSPORTATION DATA & ANALYSIS

NUMERALS INDICATE AVERAGE DAILY
TRAFFIC VOLUMES ON DESIGNATED ROADS.

TRUNK HIGHWAY ROUTES ARE 2004 A.A.D.T. VOLUMES.

FOR DESIGNATED ROADS :
/ = SEGMENT ENDPOINT FOR ALL
ROADS INTERSECTED BY HATCH
(= SEGMENT ENDPOINT ONLY FOR
ROAD SEPARATED FROM INTERSECTING
ROAD BY ARC

*NOTE: ALL FEATURES EXCEPT TOWNSHIP ROADS AND
CULTURE ARE CURRENT AS OF JANUARY 1, 2004.
NOTE: FOR DETAIL OF COUNTY STATE AID HIGHWAYS AND COUNTY
ROADS IN INCORPORATED PLACES, SEE MAPS OF MUNICIPALITIES.

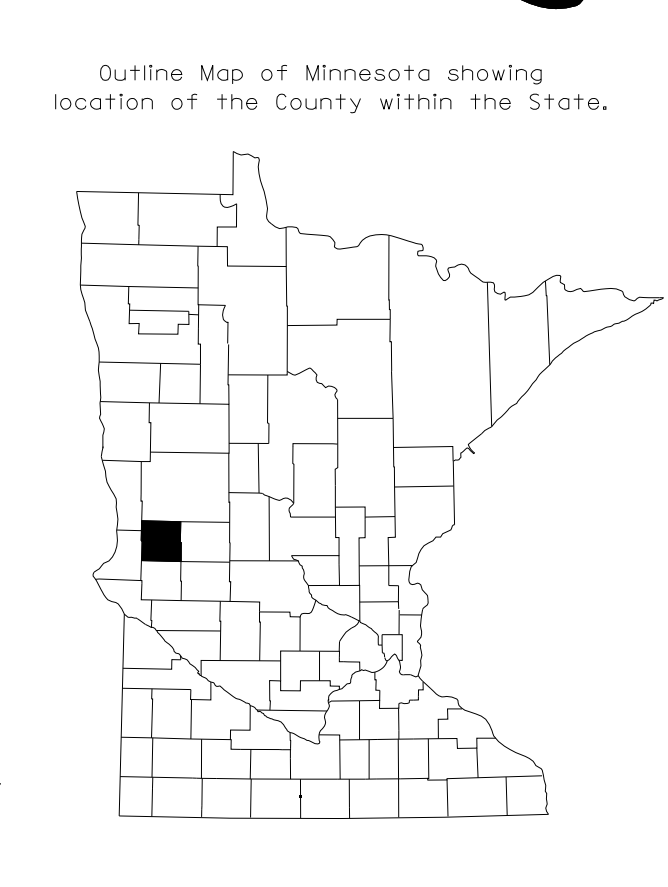

Summary statistics:
Area of this County: 576 Sq. Miles
Land Area: 547 Sq. Miles
2000 Total County Population: 6,293