

VOLUMES PREPARED BY
THE OFFICE OF
TRANSPORTATION DATA & ANALYSIS

NUMERALS INDICATE AVERAGE DAILY
TRAFFIC VOLUMES ON DESIGNATED ROADS.
TRUNK HIGHWAY ROUTES ARE 2008 A.A.D.T. VOLUMES

FOR DESIGNATED ROADS :
/ = SEGMENT ENDPOINT FOR ALL
ROADS INTERSECTED BY HATCH
= SEGMENT ENDPOINT ONLY FOR
ROAD SEPARATED FROM INTERSECTING
ROAD BY ARC

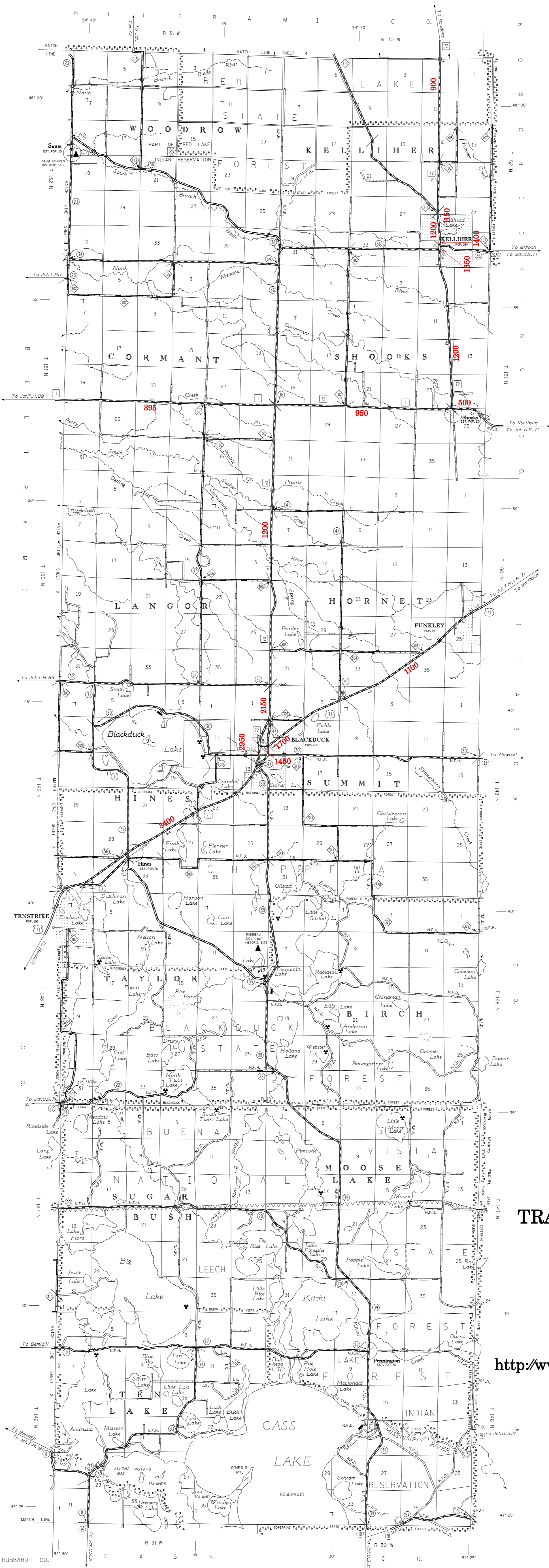

TRAFFIC VOLUMES ARE SUBJECT
TO VARIABILITY AND
CONSTRUCTION EFFECTS

FOR MORE INFO VISIT:
<http://www.dot.state.mn.us/traffic/data/html/aadt.html>

2008 TRUNK HIGHWAY VOLUMES
GENERAL HIGHWAY MAP
BELTRAMI
COUNTY
MINNESOTA

PREPARED BY THE
MINNESOTA DEPARTMENT OF TRANSPORTATION
 OFFICE OF TRANSPORTATION DATA & ANALYSIS
 IN COOPERATION WITH
U.S. DEPARTMENT OF TRANSPORTATION
FEDERAL HIGHWAY ADMINISTRATION

NORTH ARROW
 OF 1983

2008
 SCALE
 0 1 2 3 4 5 6 MILES
 0 1 2 3 4 5 6 KILOMETERS

LEGEND

ROAD AND ROADWAY FEATURES

MAINTENANCE

CONSERVATION

ROAD SYSTEM DESIGNATIONS

RESERVATION

INDUSTRIAL

FARM AND DWELING UNITS

COMMERCIAL

PUBLIC SERVICE FACILITIES

OTD CHANGES

MINNESOTA HWY FEATURES

WATER

DRAINAGE

BOUNDARIES

UNIDENTIFIED

GENERAL MAP OF MINNESOTA SHOWING LOCATION OF BELTRAMI COUNTY

QUANTILE MAP OF BELTRAMI COUNTY

Source: Minnesota Department of Transportation, Office of Transportation Data & Analysis, 2008.

*HOTELL FEATURES EXCEPT TOWNSHIP BOUNDS AND
CUTLINE ARE CURRENT AS OF JANUARY 1, 2008.
NOTE: FOR DETAIL OF COUNTY STATE AND HIGHWAY AND COUNTY
ROADS IN MINNESOTA, VISIT www.dhs.gov.

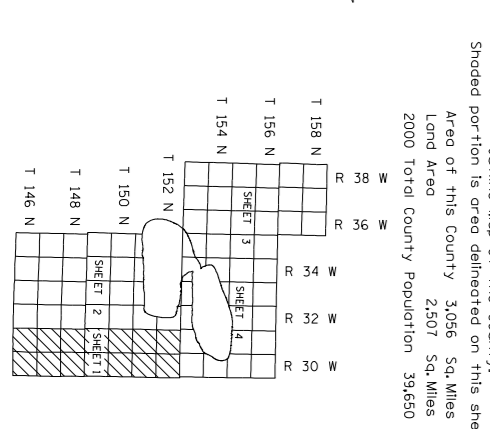
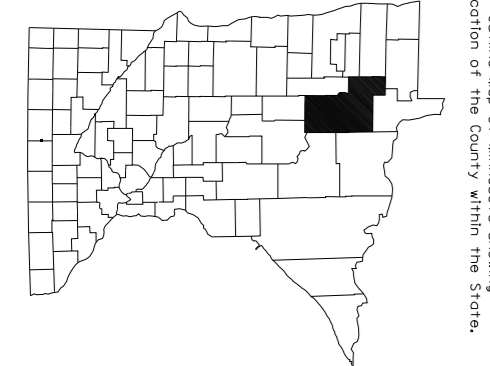

SHEET 1 OF 4