

2009 TH VOLUMES
 GENERAL HIGHWAY MAP
GOODHUE COUNTY
 MINNESOTA

PREPARED BY THE
 MINNESOTA DEPARTMENT OF TRANSPORTATION
 OFFICE OF TRANSPORTATION DATA & ANALYSIS
 IN COOPERATION WITH
 U.S. DEPARTMENT OF TRANSPORTATION
 FEDERAL HIGHWAY ADMINISTRATION

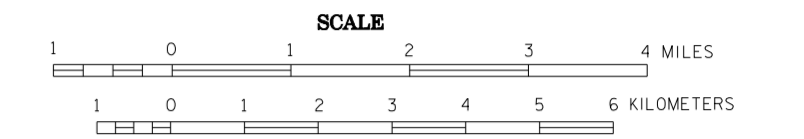

2009
 BASIC DATA - 1977*

Projections
 Minnesota Coordinate System
 South Zone
 Lambert Conformal Conic
 North American Datum
 of 1983

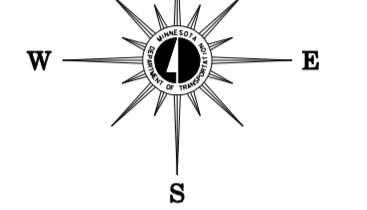

LEGEND

ROAD AND ROADWAY FEATURES	NAVIGATION
PROJECTED ROAD	BASE LINES ON NATURAL STREAMS
UNIMPROVED ROAD	SHIP LINES ON TRAILING LINES
GRADED AND DRAINED ROAD	DOCK, PIER OR LANDING
SOIL SURFACE ROAD	NAVIGABLE STREAM
GRAVEL OR STONE ROAD	LANDMARK LIGHT BEACON
BITUMINOUS ROAD	LIGHTHOUSE
PAVED ROAD	
ROAD UNDER CONSTRUCTION	
ROADS IN UNINCORPORATED PLACES	
ROADS WITHIN MANICIPALITIES AND PREVIOUS ROADS	
POINTS BETWEEN WHICH DISTANCES ARE INDICATED	
GRADE SEPARATION	
FULL TRAFFIC INTERCHANGE	
PARTIAL TRAFFIC INTERCHANGES INDICATING TRAFFIC MOVEMENT	
ROAD SYSTEM DESIGNATIONS	CONSERVATION
INTERSTATE TRUNK HIGHWAY	FOREST RANGER STATION
STATE NUMBERED TRUNK HIGHWAY	GUARD OR BRIDGE STATION
COUNTY STATE AID HIGHWAY	NOT PERMANENTLY OCCUPIED
COUNTY STATE AID IN ADJUTANT COUNTY	GAME PRESERVE
STATE PARK ROAD	SECURITY OR LOOKOUT TOWER
	PERMANENT ELEVATION
	MINI PAVILION
	M* = MUNICIPAL W* = WATERSIDE
	PUBLIC ACCESS POINT
RAILROADS	RECREATION
RAILROADS IN ADJUTANT COUNTY OR BY TRAINS OF ANOTHER OPERATING COMPANY OR BY TRAINS OF ANOTHER CARRIED UNDER THROUGH ROUTES	GOLF COURSE OR COUNTRY CLUB
RAILROADS IN ADJUTANT COUNTY OR BY TRAINS OF ANOTHER OPERATING COMPANY OR BY TRAINS OF ANOTHER CARRIED UNDER THROUGH ROUTES	ATLETIC FIELD
RAILROAD STATION	PLAYGROUND
GRADE CROSSING	BATHING BEACH OR SWIMMING POOL
OVERPASS HIGHWAY ABOVE	CAMP SITE
	CAMP OR LODGE
ARWAYS	FARM AND DWELLING UNITS
MILITARY FIELD	FARM UNIT
COMMERCIAL OR MANICIPAL FIELD	BARNS OR DOMESTIC FOR STUDENTS
COMPLETE FACILITIES	WORKSHOPS
LIMITED FACILITIES	SEASONAL DWELLING
LANDING AREA OR STRIP	HOME OR GROUP OF BUILDINGS CLOSELY SPACED
SEAPLANE BASE	NUMBER OF UNITS TO THE SYMBOL
ARWAY LIGHT BEACON/GENERAL	INDICATED NUMBER OF EACH UNIT
RAISER WARE STATION	SHOWS OUT OF POSITION
STRUCTURES	INDUSTRIAL
GENERAL SYMBOLS (OVER 20' SPAN)	FACTORY OR INDUSTRIAL PLANT
SMALL BRIDGES (CLOSELY SPACED)	STORAGE TANKS, OIL OR GAS
SHARPER	BEET SAMP
GENERAL SYMBOLS (OVER 20' SPAN)	STOCKYARD/FIELD
GENERAL	QUARRY/LEGACY OR CHEESE FACTORY
SHARPER	WAREHOUSE
ARCH	
TRUSS	
RECTANGULAR BRIDGE	
DAW WITH ROAD (SMALL SCALE)	
DAW WITH ROAD (LARGE SCALE)	
DAW WITHOUT ROAD (SMALL SCALE)	
LEVELS ON SIDE	
LEVELS ON SIDE WITH ROAD	
WOOD STRUCTURES 10 TO 20'	
CONCRETE FORD OR SIP	
FORD - ROAD ESTABLISHED	
BOUNDARIES	PUBLIC SERVICE FACILITIES
NATIONAL OR STATE	POST OFFICE
COUNTY	MUNICIPAL LIBRARY
CITY/TOWNSHIP	PUBLIC HEALTH
CONGRESSIONAL TOWNSHIP (U.S. LAND)	RAILROAD STATION
SECTION LINE	SEASIDE COTTAGE PLANT
CONGRESSIONAL AREA	MUNICIPAL HOME
NATIONAL OR STATE PARK	HOSPITAL
NATIONAL OR STATE FOREST	CONVENTIONAL INSTITUTION
INDIAN RESERVATION	STATE CAPITAL
ASBESTOS	CITY CENTER
MILITARY MANICIPAL AREA (STATE OR FEDERAL AREA FEDERAL)	UNINCORPORATED CITY (GENERALIZED)
WITH LINE BETWEEN ADJOINING SHEETS OF THE SAME COUNTY	UNINCORPORATED COMMUNITY
DRAINAGE	MISCELLANEOUS MAP FEATURES
INTERMITTENT STREAM	CHURCH/OTHER RELIGIOUS INSTITUTIONS
NARROW STREAM	CHURCH WITH ENTRANCE ADJACENT
WIDE STREAM	CHURCH WITH ENTRANCE ADJACENT
WASH OR DRAMP LAND	CHURCH WITH ENTRANCE ADJACENT
DRAINAGE BIFURCATION	CHURCH WITH ENTRANCE ADJACENT
LAKE OR POND	CHURCH WITH ENTRANCE ADJACENT

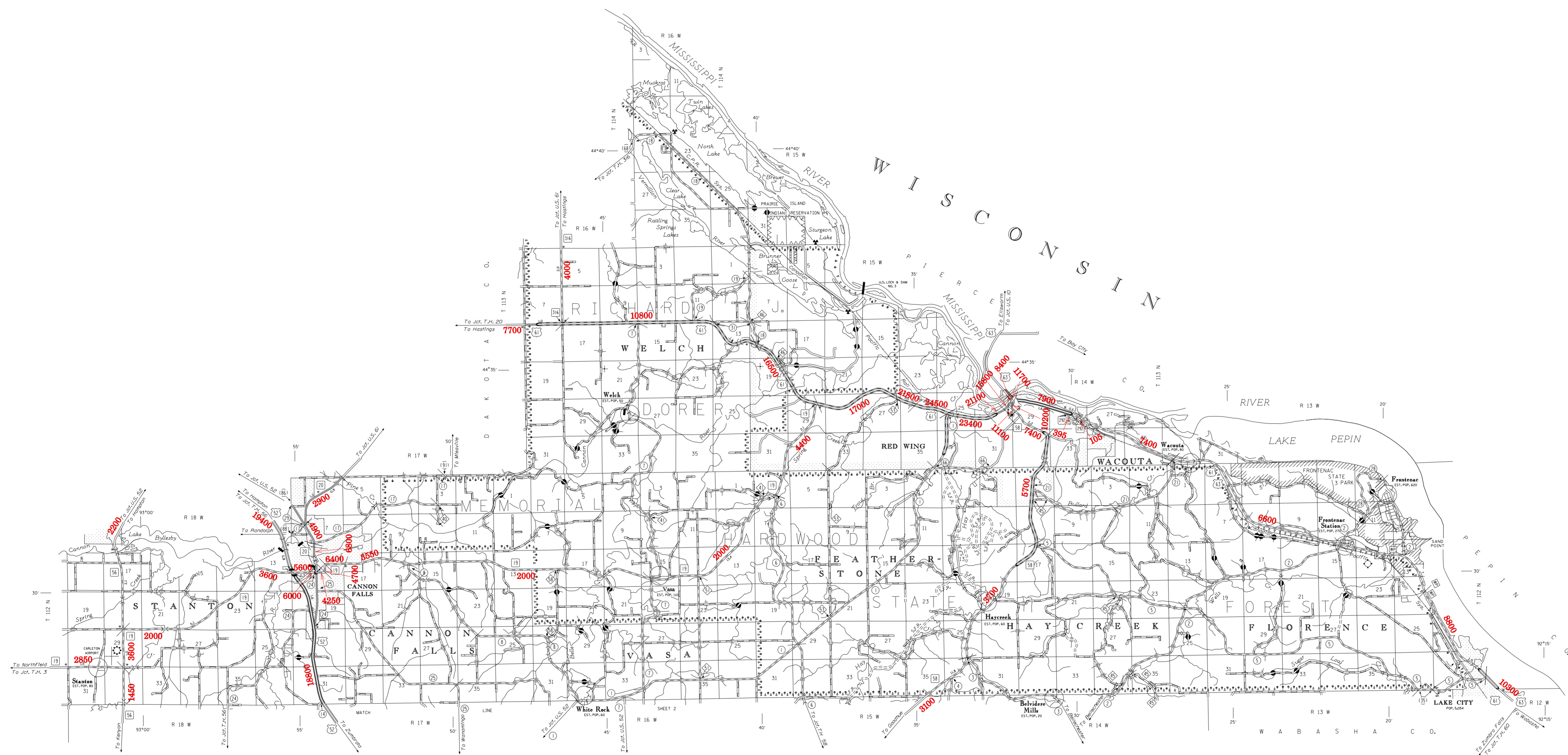

TRAFFIC VOLUMES ARE SUBJECT TO VARIABILITY AND CONSTRUCTION EFFECTS
 FOR MORE INFO VISIT: <http://www.dot.state.mn.us/traffic/data/html/aadt.html>

VOLUMES PREPARED BY
 THE OFFICE OF
 TRANSPORTATION DATA & ANALYSIS

NUMERALS INDICATE AVERAGE DAILY
 TRAFFIC VOLUMES ON DESIGNATED ROADS.
 TRUNK HIGHWAY ROUTES ARE 2009 A.A.D.T. VOLUMES

FOR DESIGNATED ROADS :
 / = SEGMENT ENDPOINT FOR ALL
 ROADS INTERSECTED BY HATCH
 (= SEGMENT ENDPOINT ONLY FOR
 ROAD SEPARATED FROM INTERSECTING
 ROAD BY ARC

*NOTE: ALL FEATURES EXCEPT TOWNSHIP ROADS AND
 CULTURE ARE CURRENT AS OF JANUARY 1, 2009.
 NOTE: FOR DETAIL OF COUNTY STATE AID HIGHWAYS AND COUNTY
 ROADS IN INCORPORATED PLACES, SEE MAPS OF MANICIPALITIES.

